

ISLE OF MAN GOVERNMENT: GENERAL REGISTRY

ASYLUM PLANS: PARISH OF BALLAUGH

- 63 Original monotone
- 64 Original coloured (decorative)

1:23

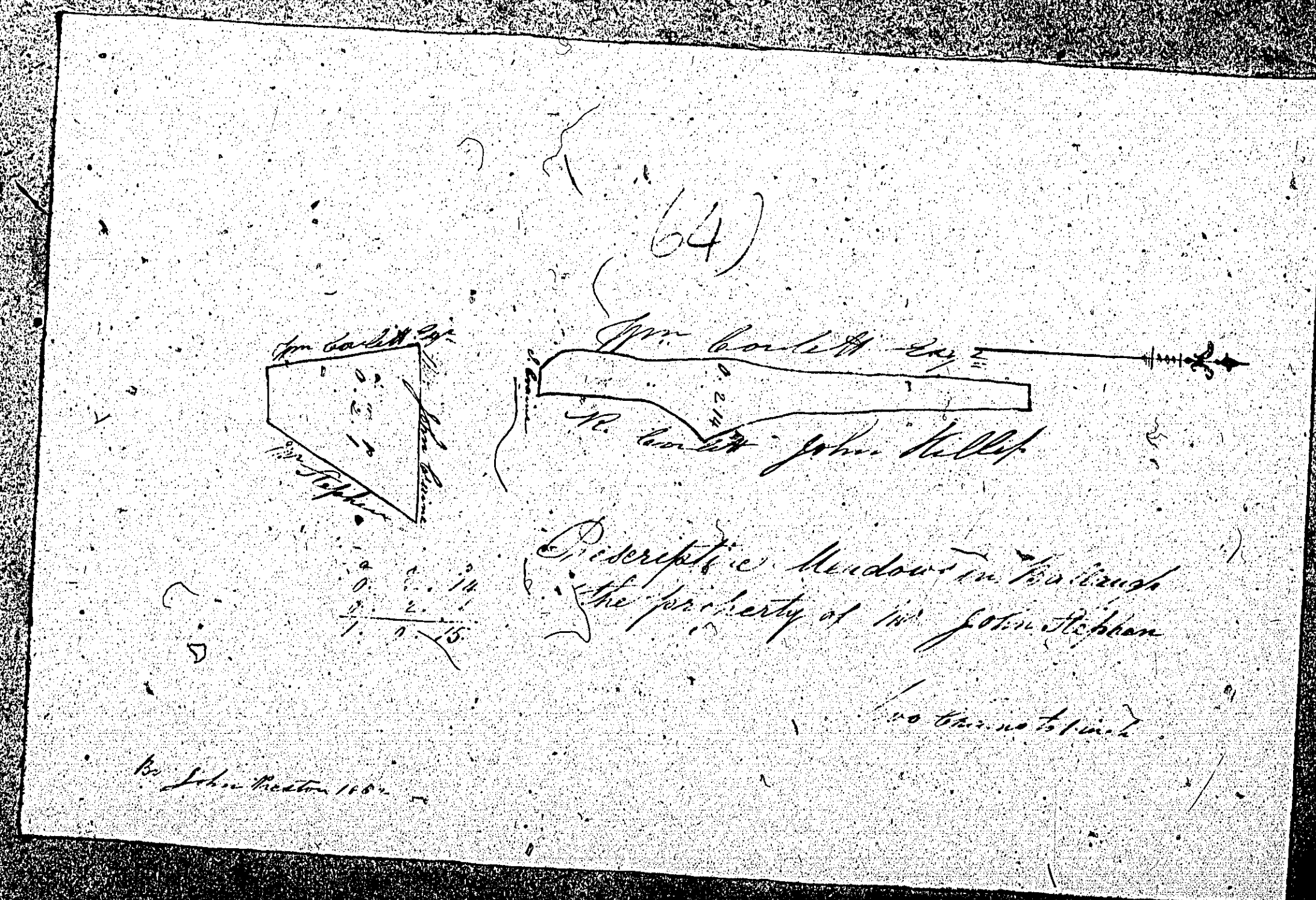
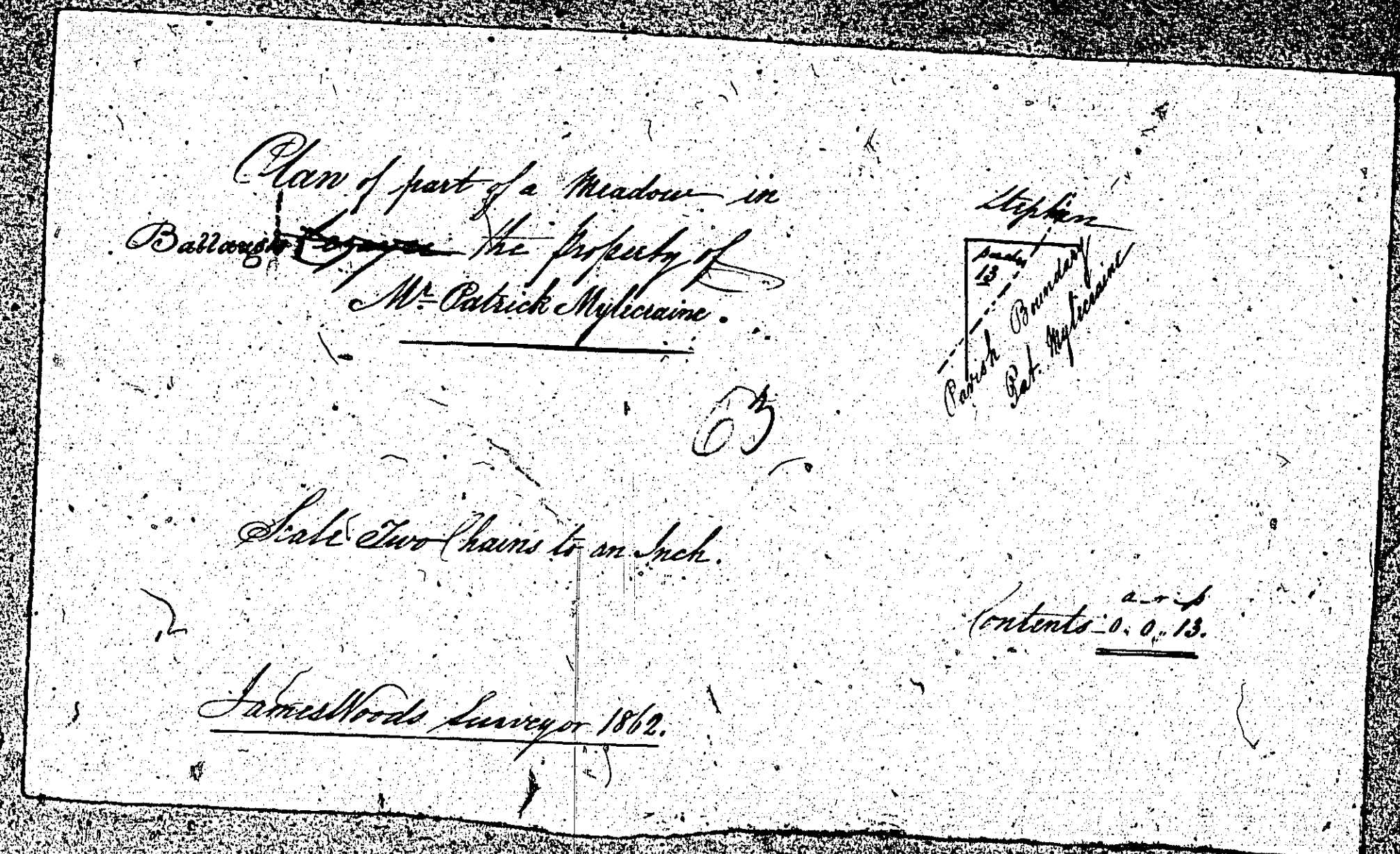



ISLE OF MAN GOVERNMENT: GENERAL REGISTRY

ASYLUM PLANS: PARISH OF BALLAUGH

- 65 Original coloured (decorative)
- 66 Original coloured

1:23

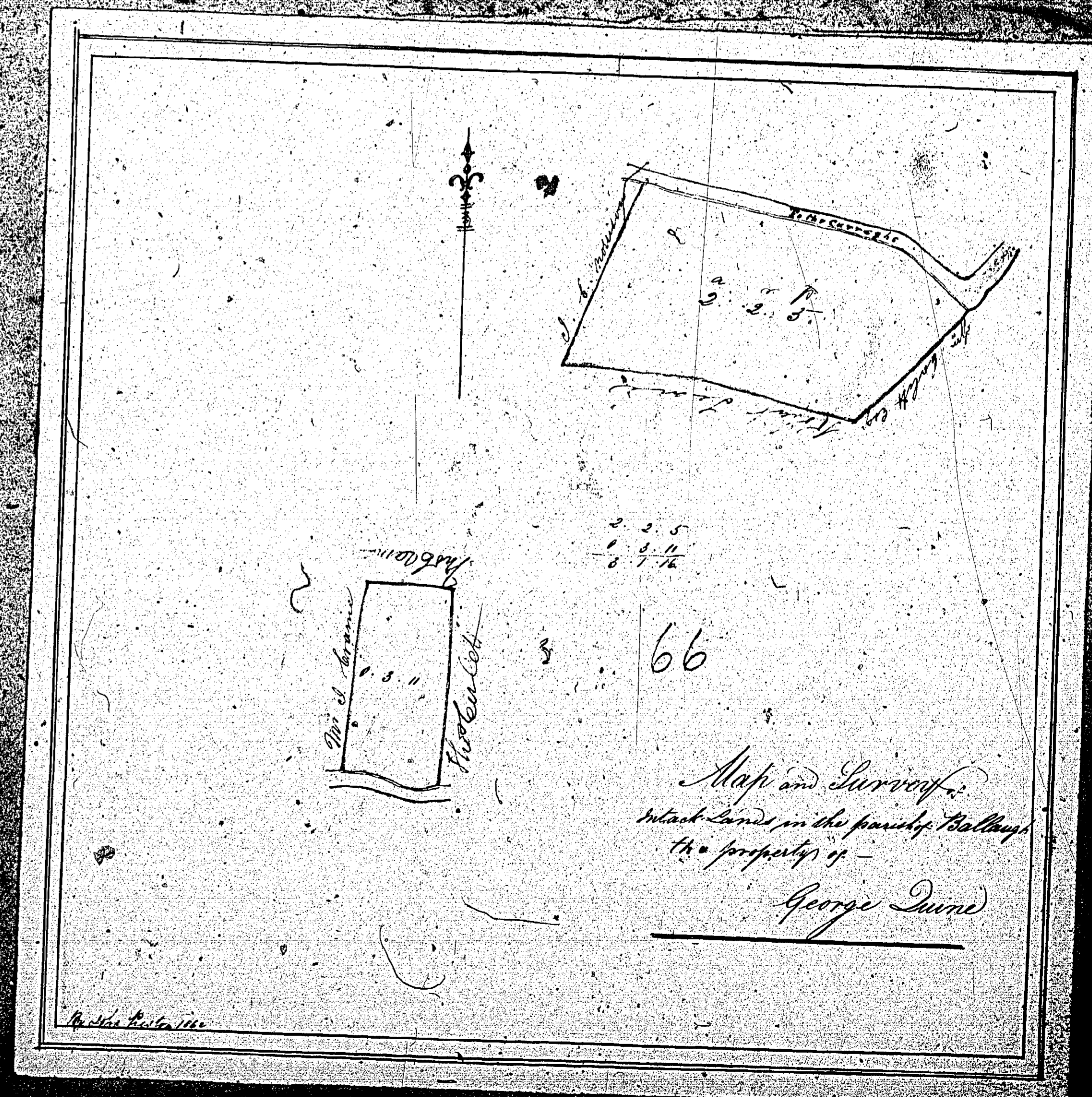
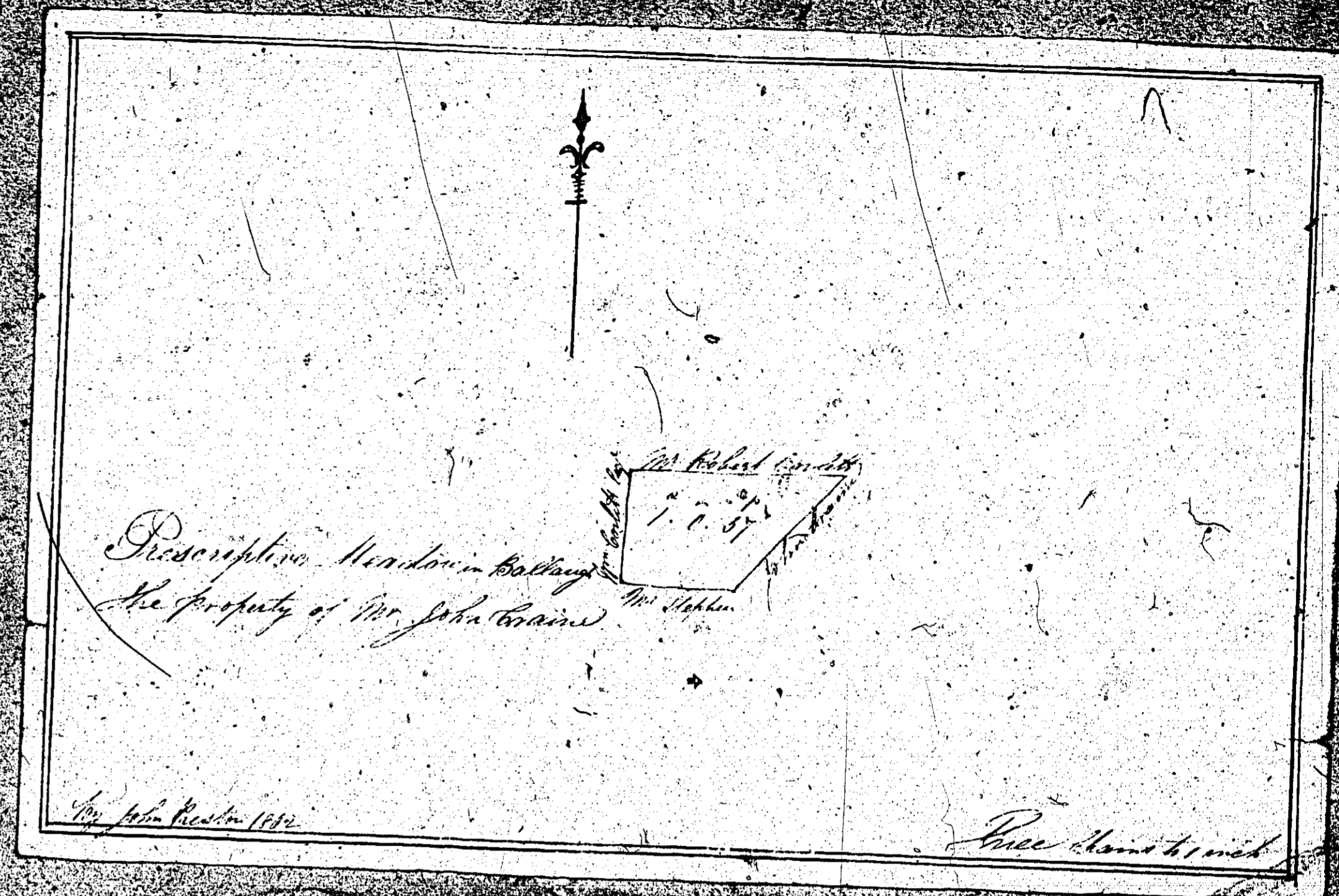



ISLE OF MAN GOVERNMENT: GENERAL REGISTRY

ASYLUM PLANS: PARISH OF BALLAUGH

Original coloured

1:23

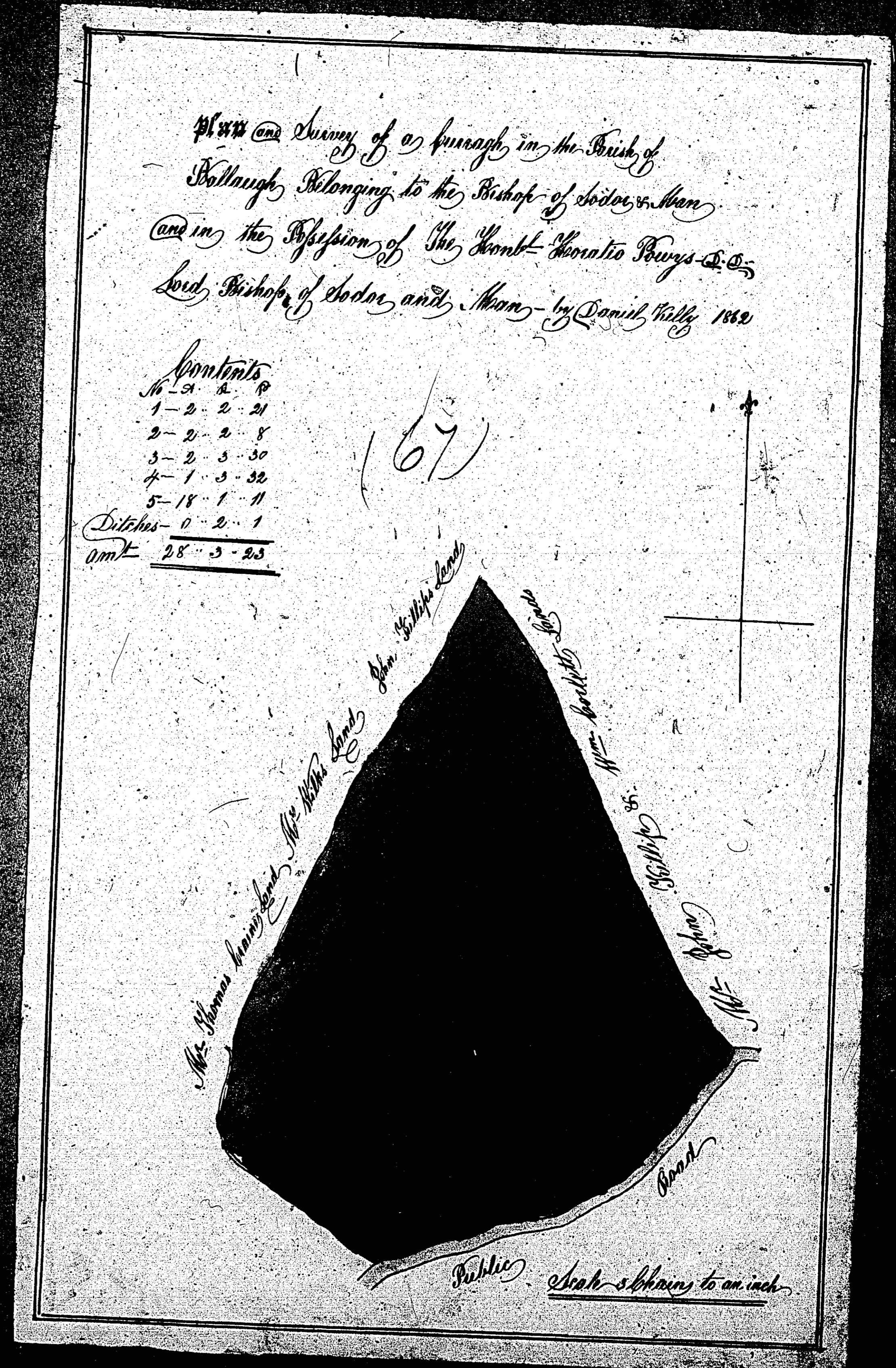



ISLE OF MAN GOVERNMENT: GENERAL REGISTRY

ASYLUM PLANS: PARISH OF BALLAUGH

1:23

- 68 Original coloured (decorative)
- 69 Original monotone

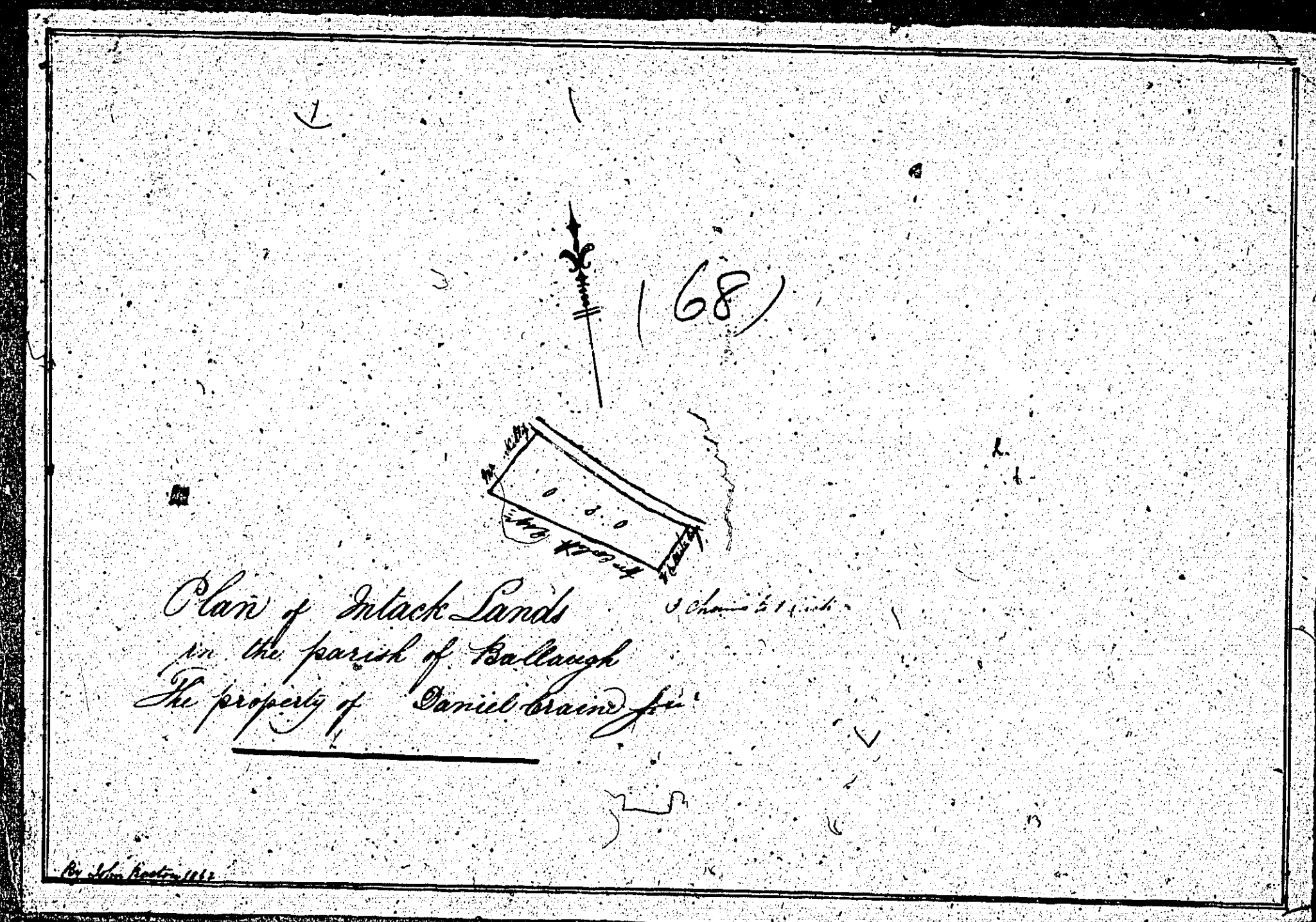

*Plan of Intack Sands  
in the parish of Ballaugh  
the property of Daniel Brandy*

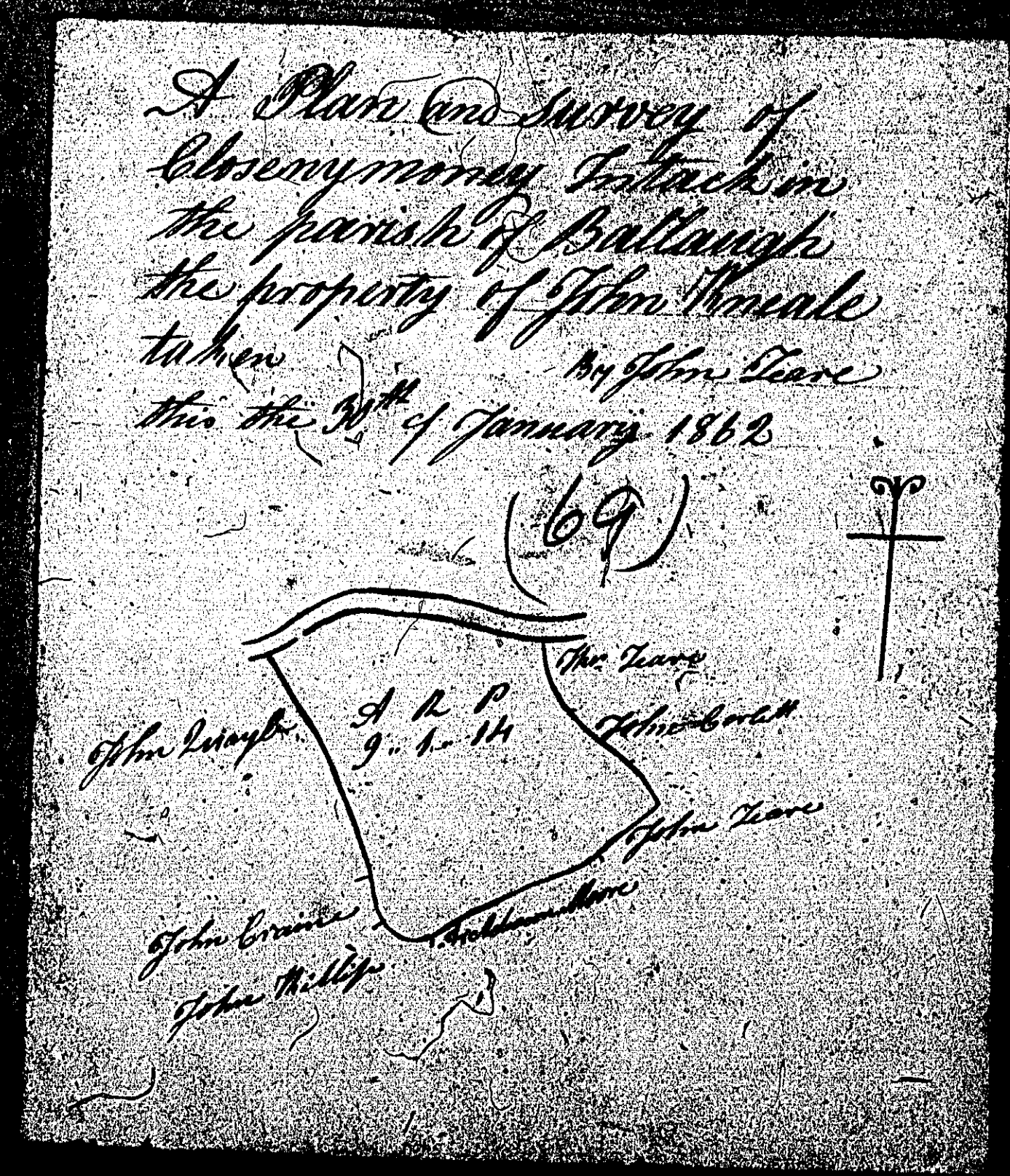

*A Plan and Survey of  
Clooneymore, Ballaugh, in  
the parish of Ballaugh  
the property of John Brandy  
taken by John Seave  
this the 11th of January 1862*

*(69)*  
*The Name  
A. R. P.  
9. 1. 14  
John Brandy  
John Brandy  
John Brandy*







ISLE OF MAN GOVERNMENT: GENERAL REGISTRY

ASYLUM PLANS: PARISH OF BALLAUGH

Originals monotone

1:23

