

ISLE OF MAN GOVERNMENT: GENERAL REGISTRY

ASYLUM PLANS: PARISH OF ARBORY

Original monotone

1:23

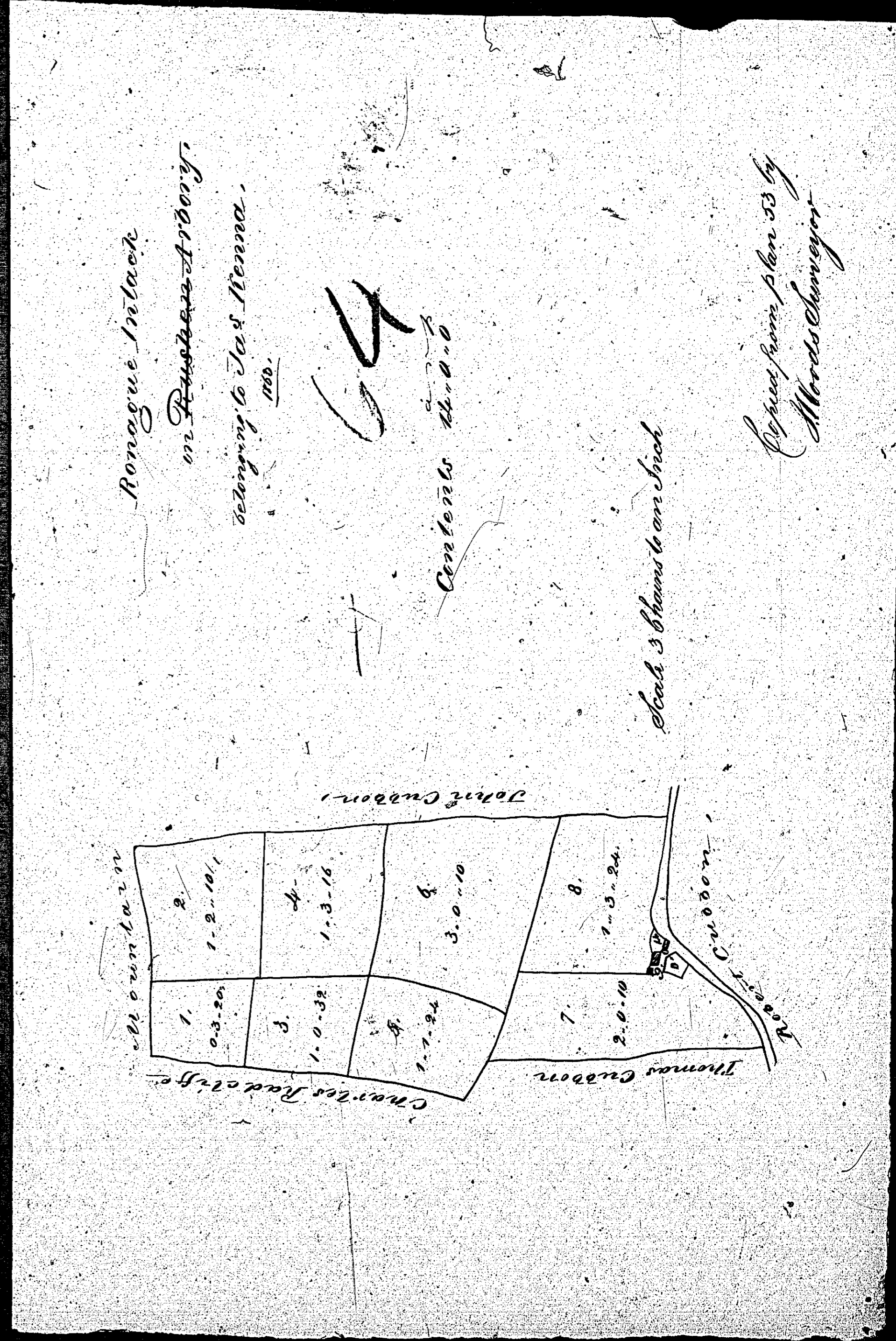

*Plan of the Garee Wood
in the Parish of Arbury
The Property of
William Callister Esq.
1865*

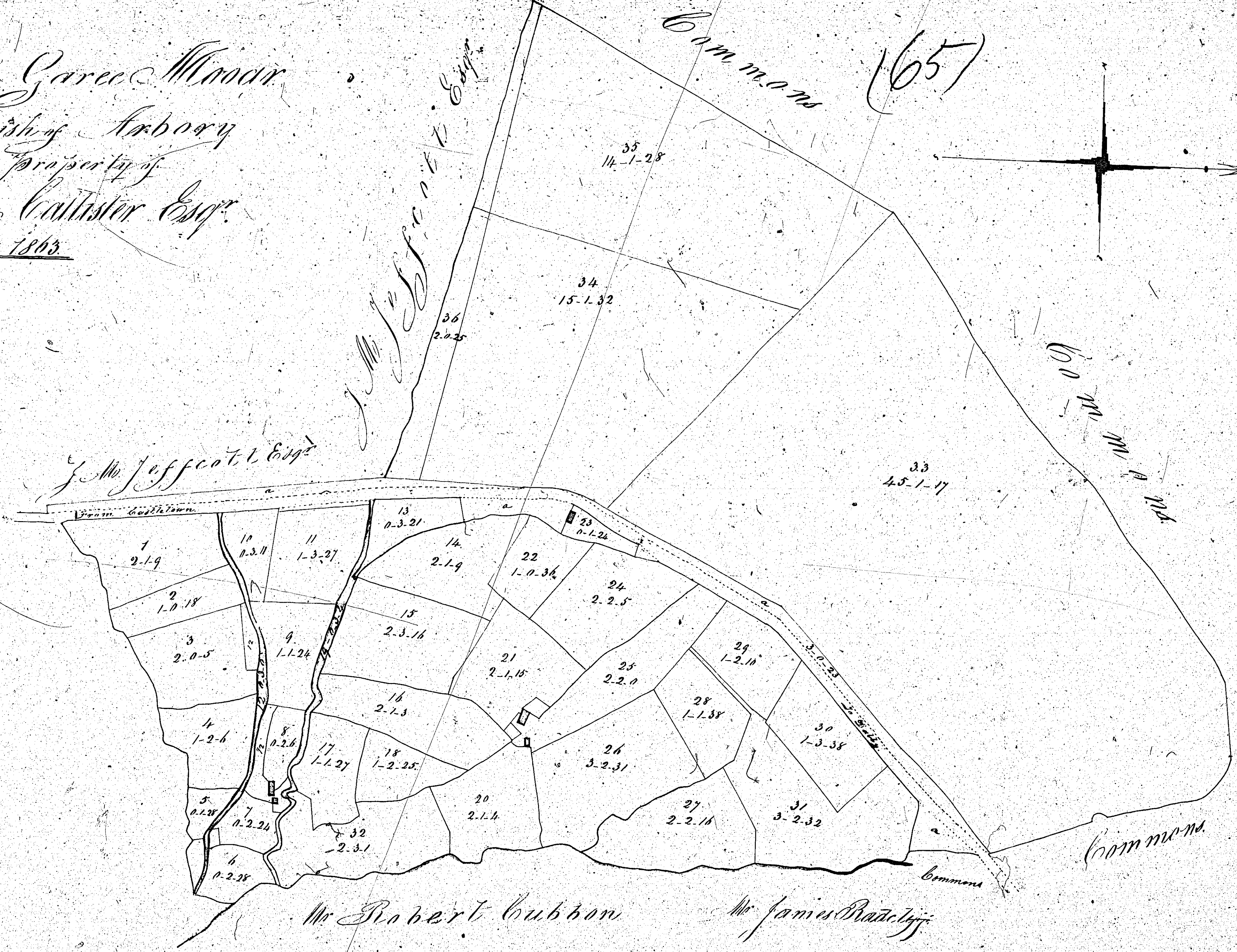

Acres	Roods	Poles
2	1	9
1	0	18
2	0	5
1	2	6
1	1	28
0	2	28
0	2	26
1	1	24
0	5	11
1	3	27
0	5	0
2	1	9
2	3	16
2	1	5
1	1	27
1	2	25
0	3	4
2	1	15
1	0	36
1	1	24
2	2	5
2	2	0
3	2	31
2	2	16
1	1	38
1	2	10
1	3	38
5	2	32
2	3	1
4	1	17
1	3	32
1	4	28
2	1	25
3	0	23
13	5	36

Unenclosed lands adjoining the roads. Total

Scale of Chains

ISLE OF MAN GOVERNMENT: GENERAL REGISTRY
ASYLUM PLANS: PARISH OF ARBORY

Original coloured

1:23

W. D. G. S. 1865

ISLE OF MAN GOVERNMENT: GENERAL REGISTRY

ASYLUM PLANS: PARISH OF ARBORY

Original coloured

1:23

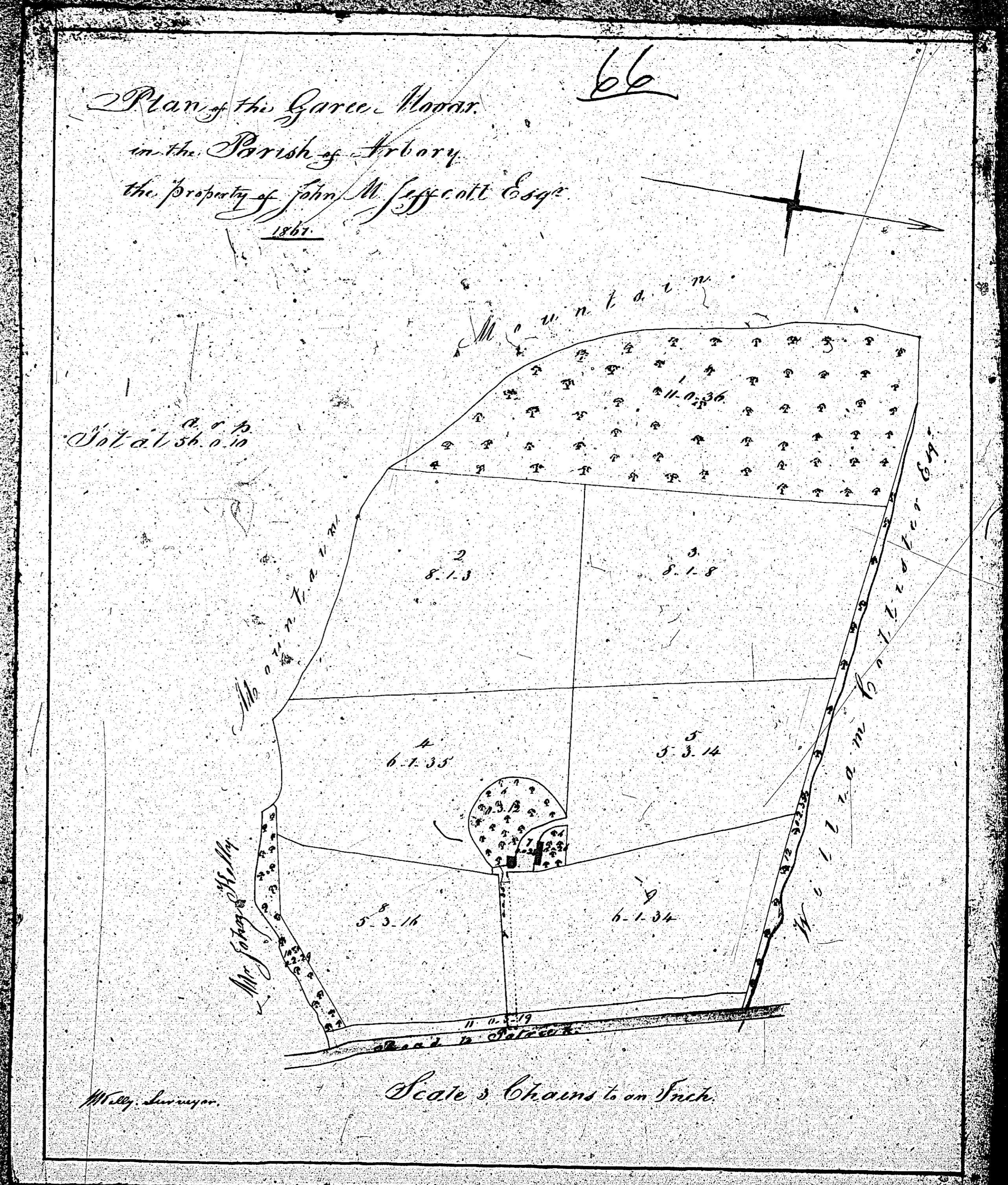

ISLE OF MAN GOVERNMENT: GENERAL REGISTRY

ASYLUM PLANS: PARISH OF ARBORY

Original monotone

1:23

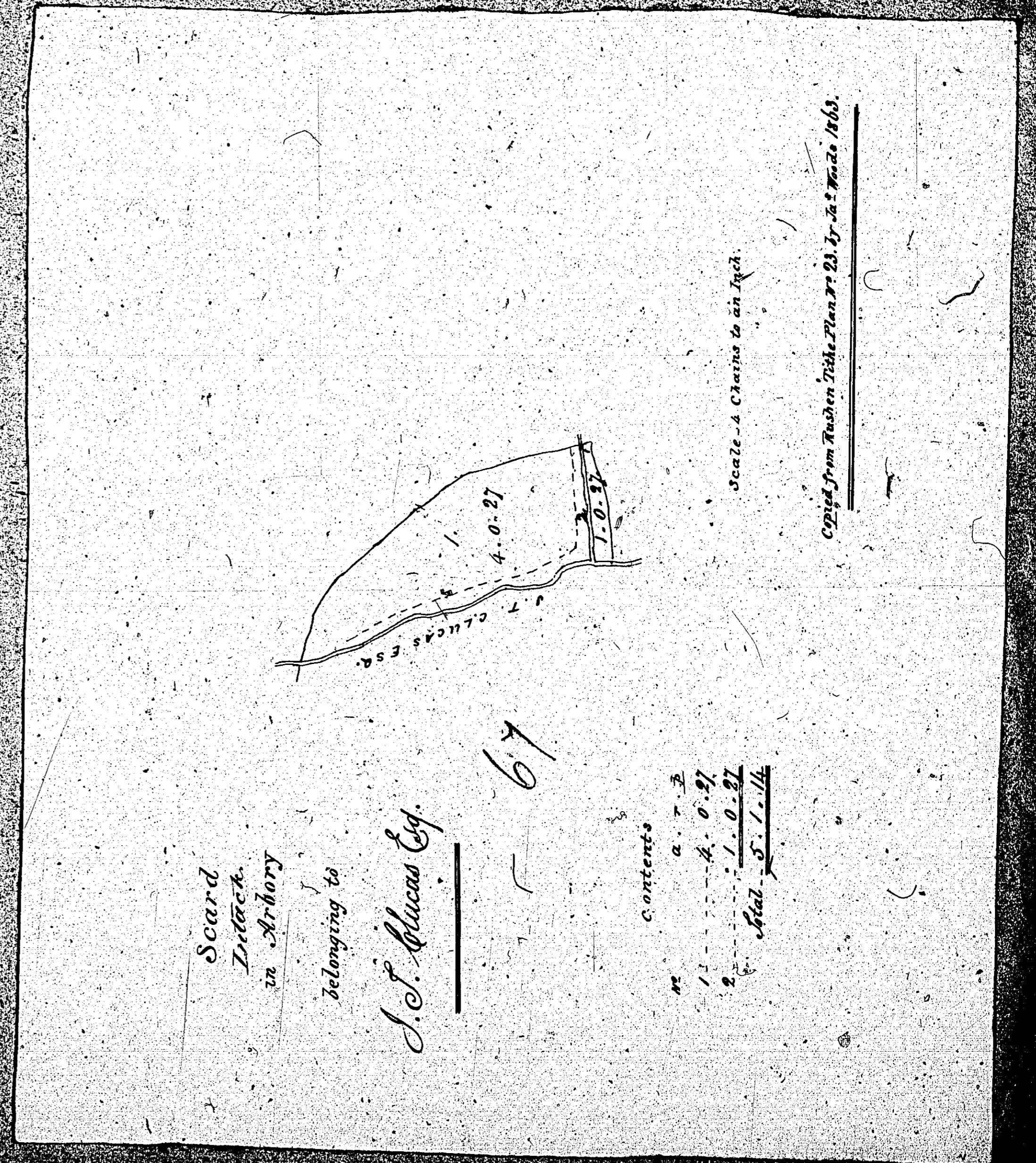

ISLE OF MAN GOVERNMENT: GENERAL REGISTRY

ASYLUM PLANS: PARISH OF ARBORY

Original monotone

1:23

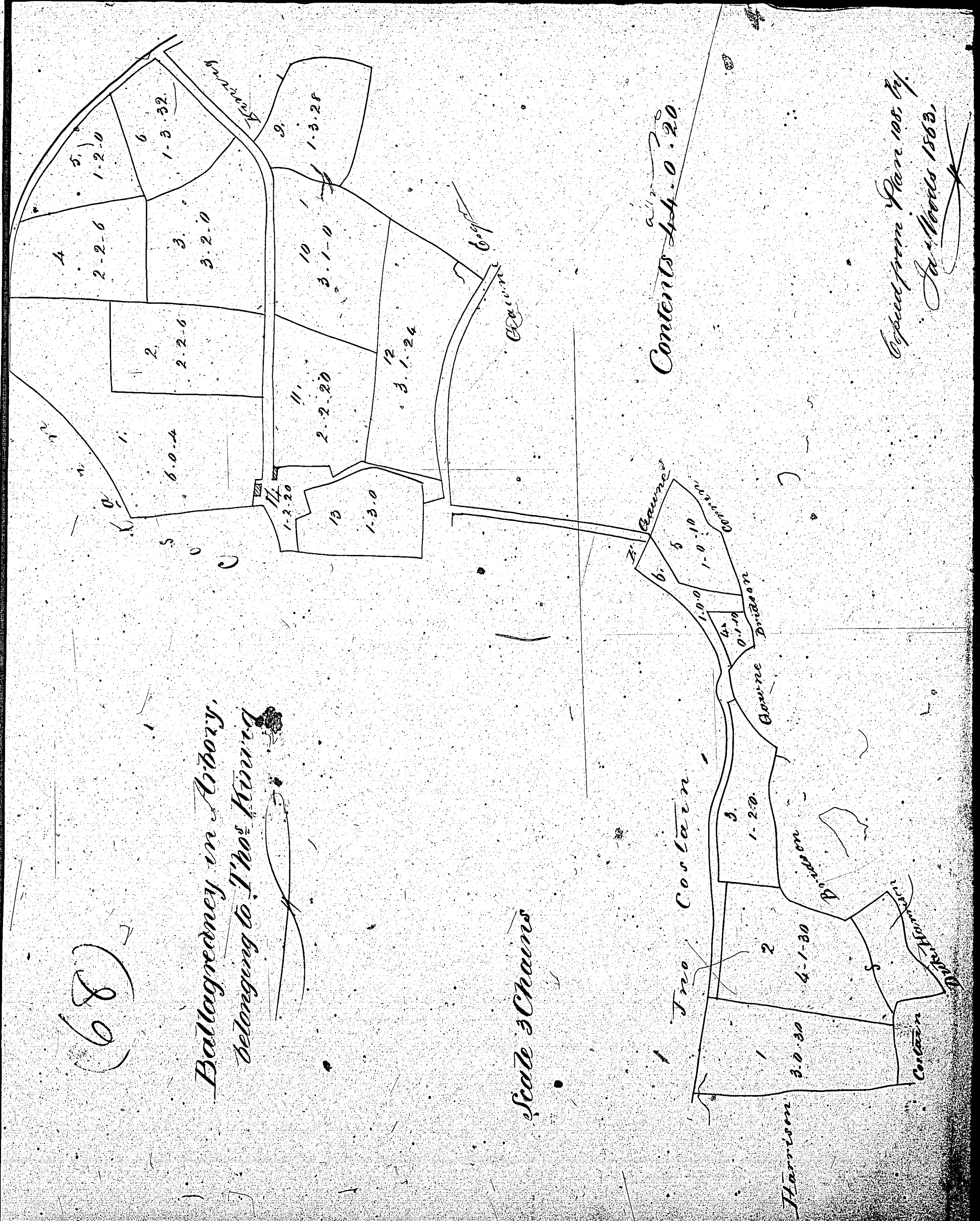

Copied from Plan 100, by
J. J. Woods 1883.

Plan 69 is bound
out of sequence
with plans
72 and 73