

ISLE OF MAN GOVERNMENT: GENERAL REGISTRY

ASYLUM PLANS: PARISH OF ARBORY

Originals monotone

1:23

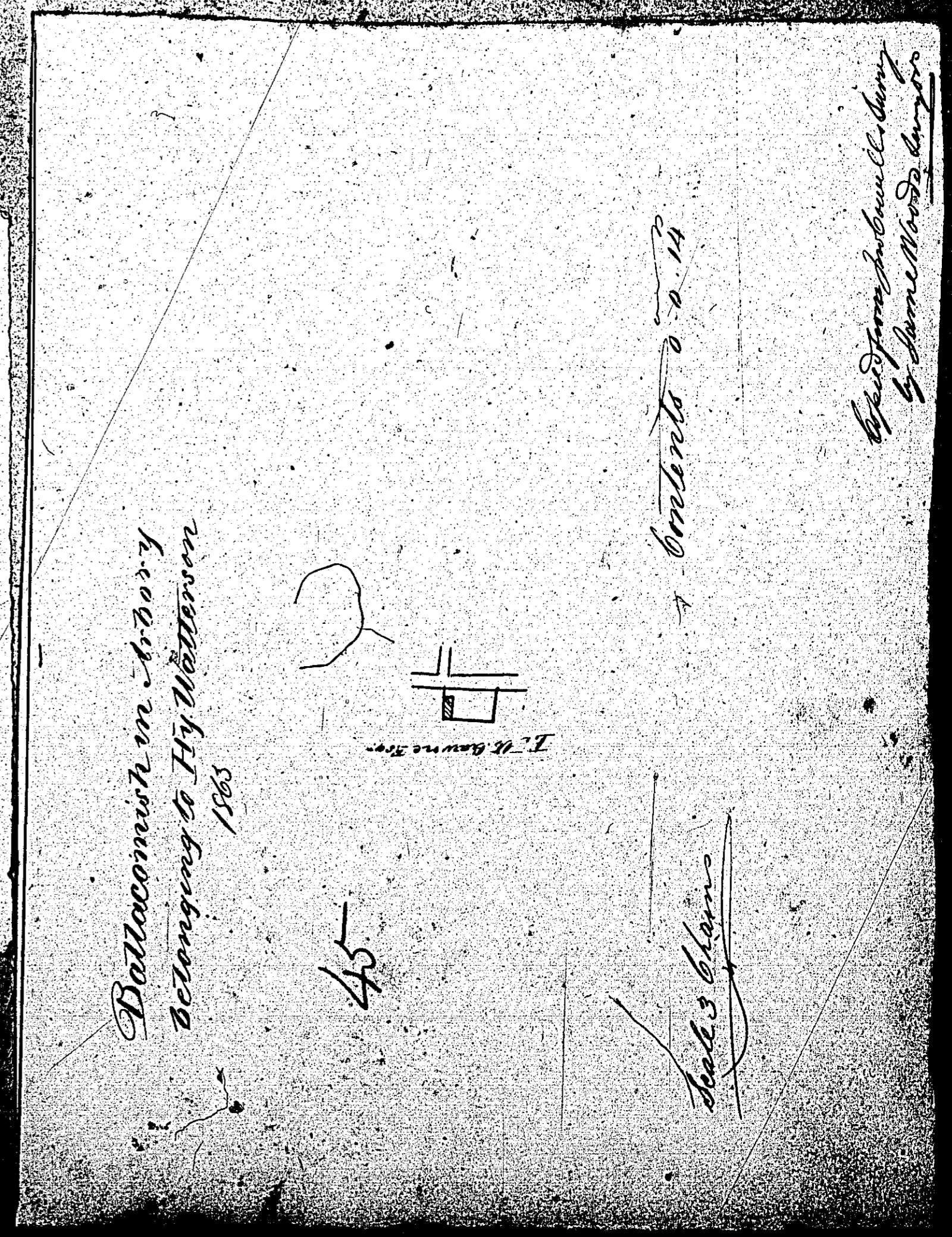
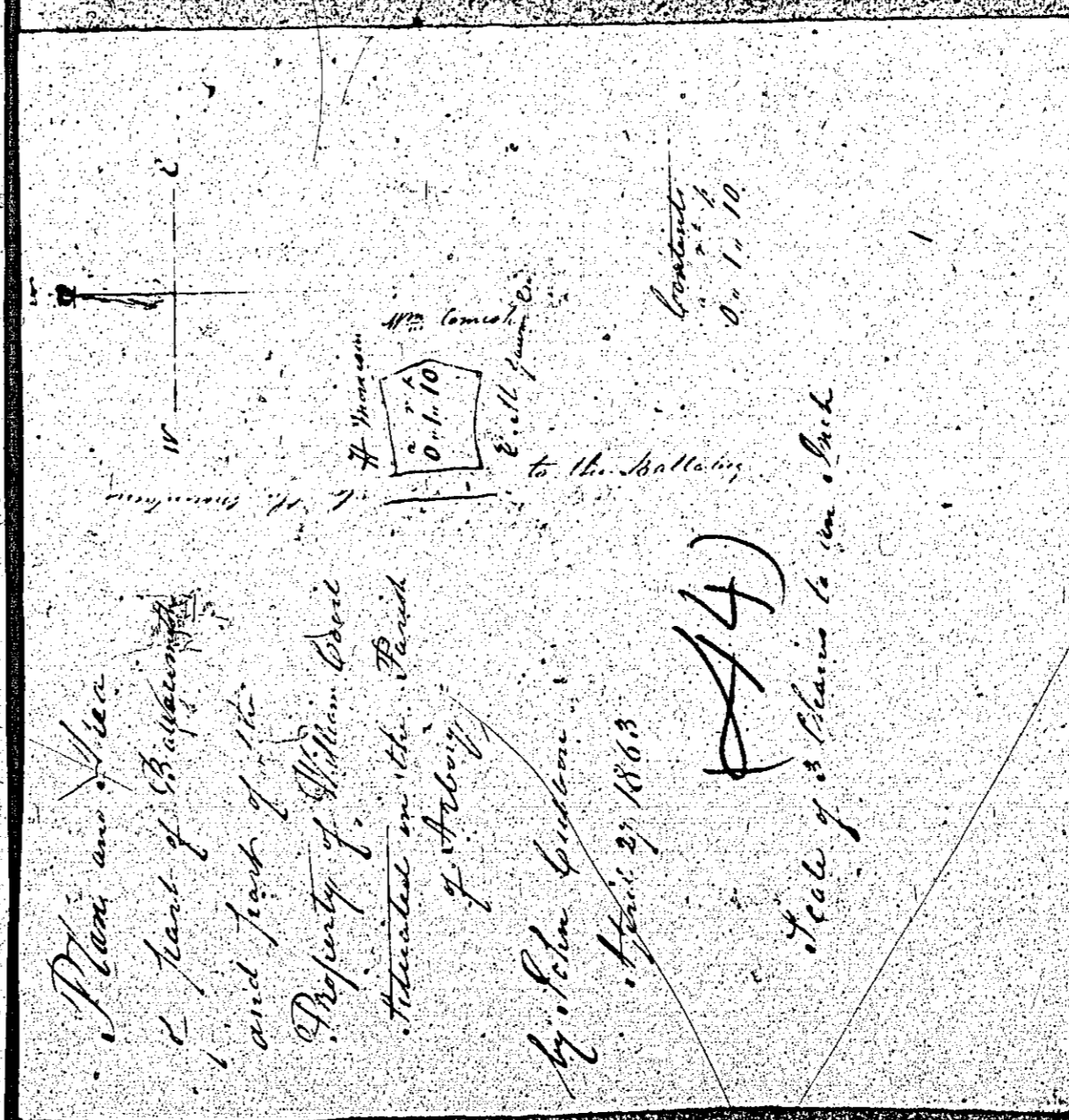
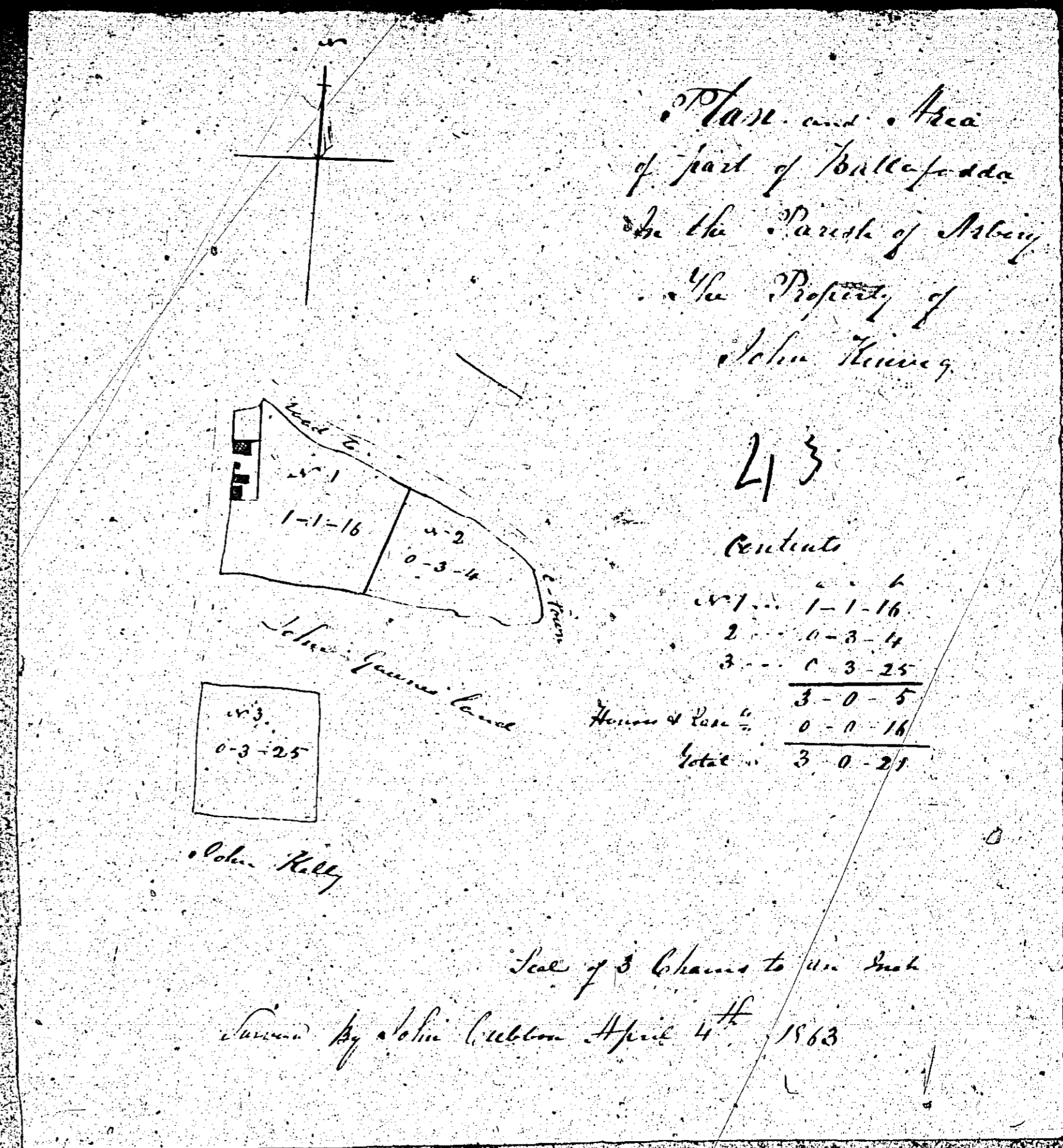

ISLE OF MAN GOVERNMENT: GENERAL REGISTRY

ASYLUM PLANS: PARISH OF ARBORY

Originals monotone

1:23

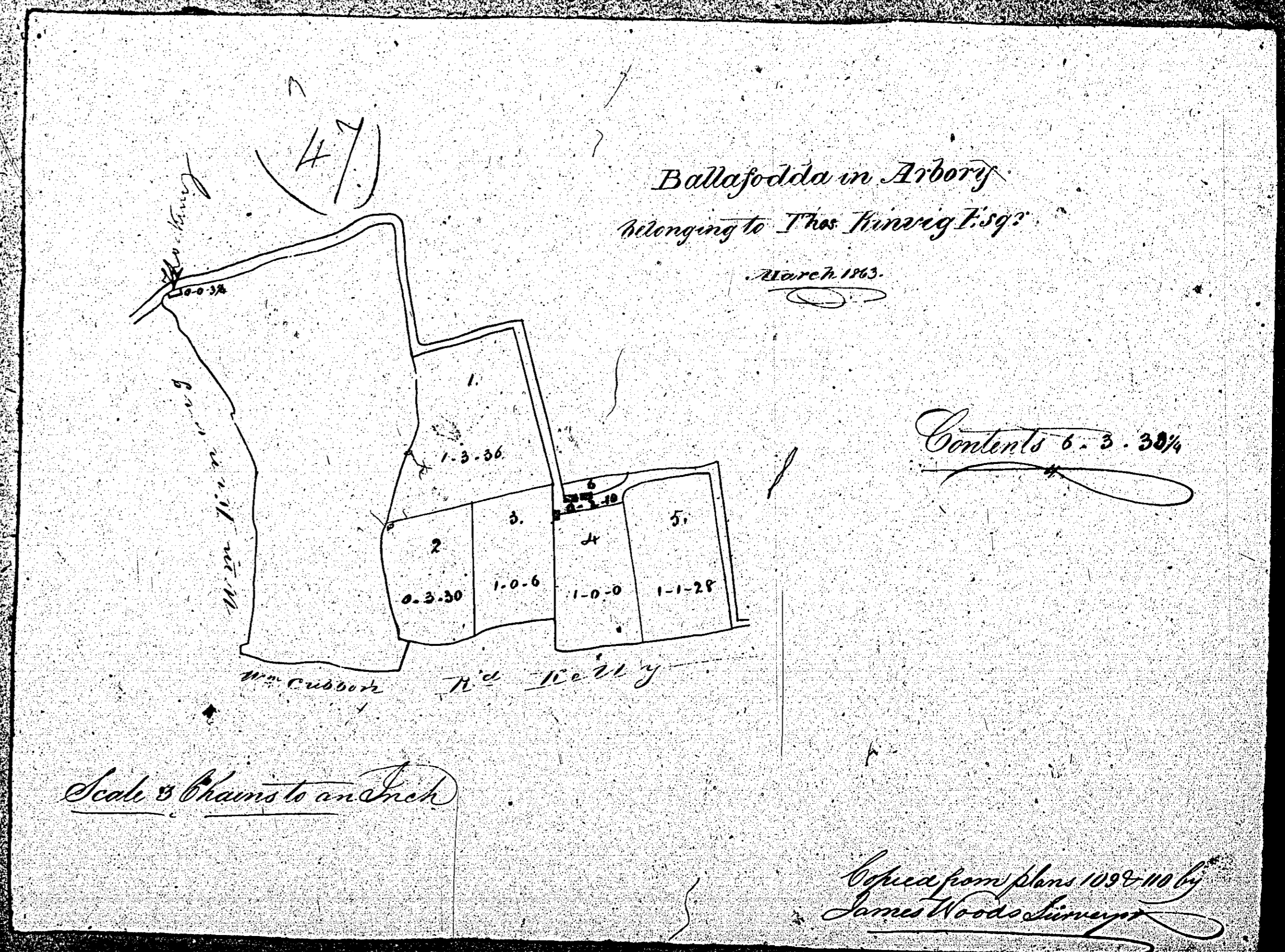
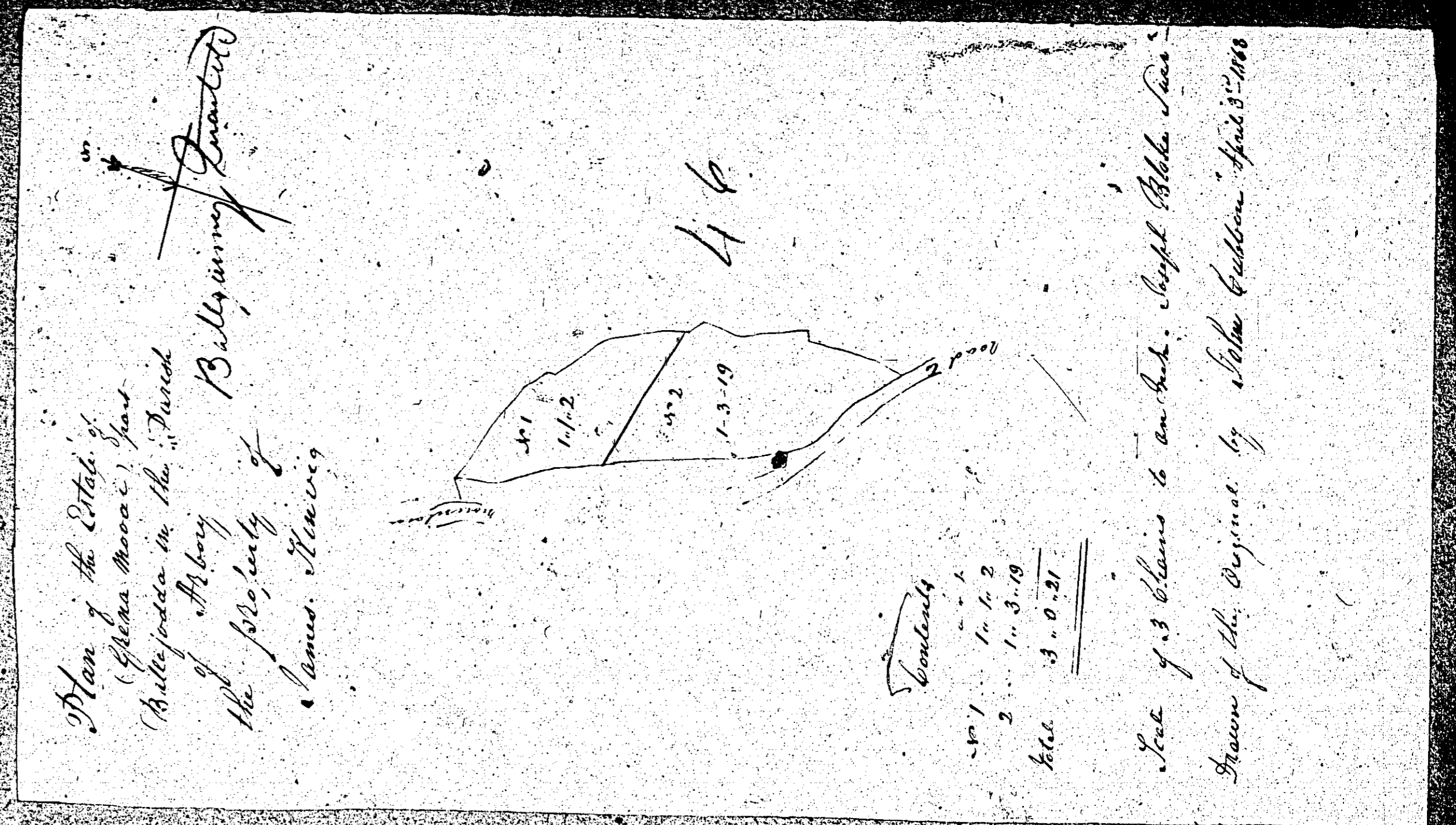

ISLE OF MAN GOVERNMENT: GENERAL REGISTRY

ASYLUM PLANS: PARISH OF ARBORY

Originals monotone

1:23

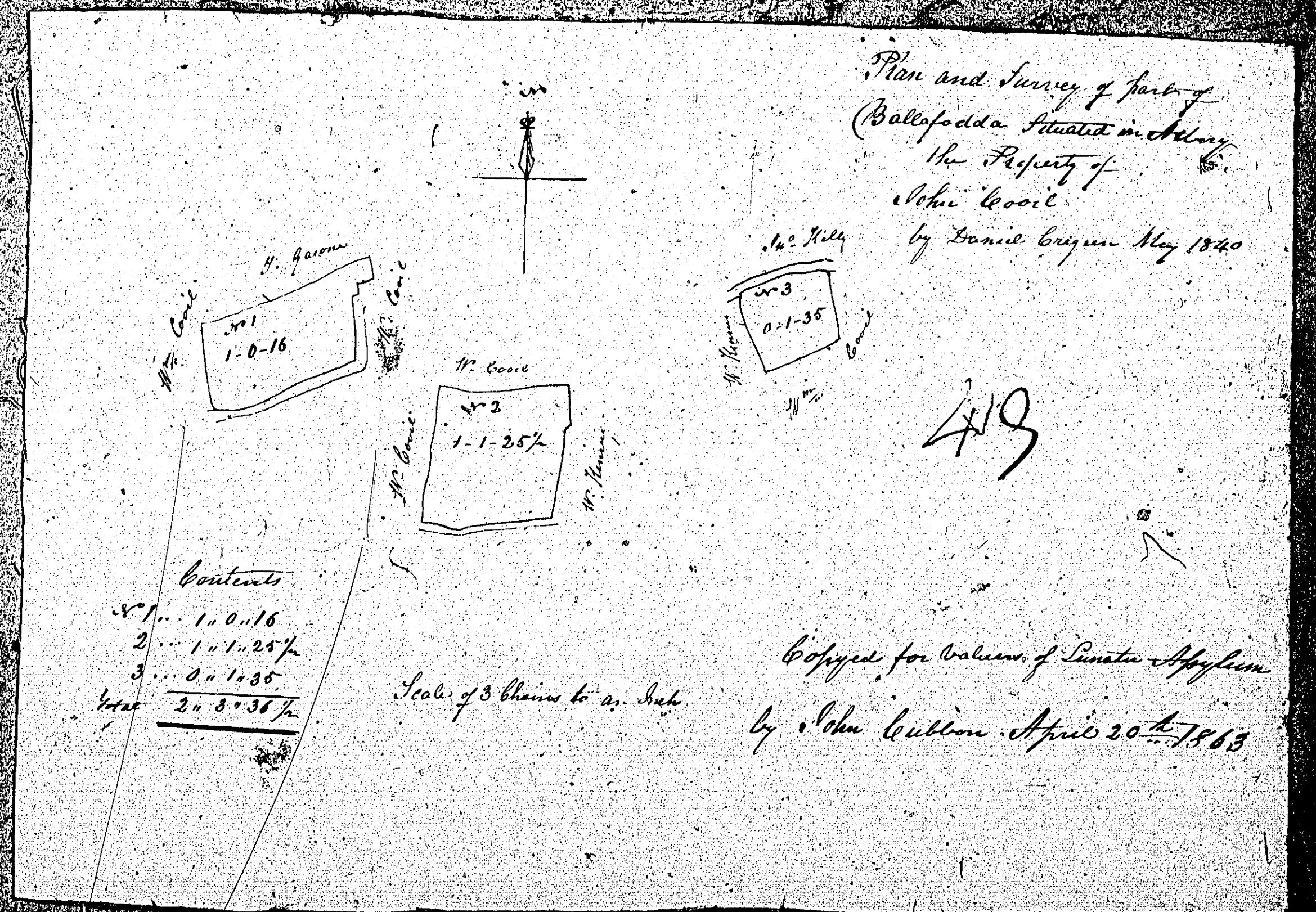
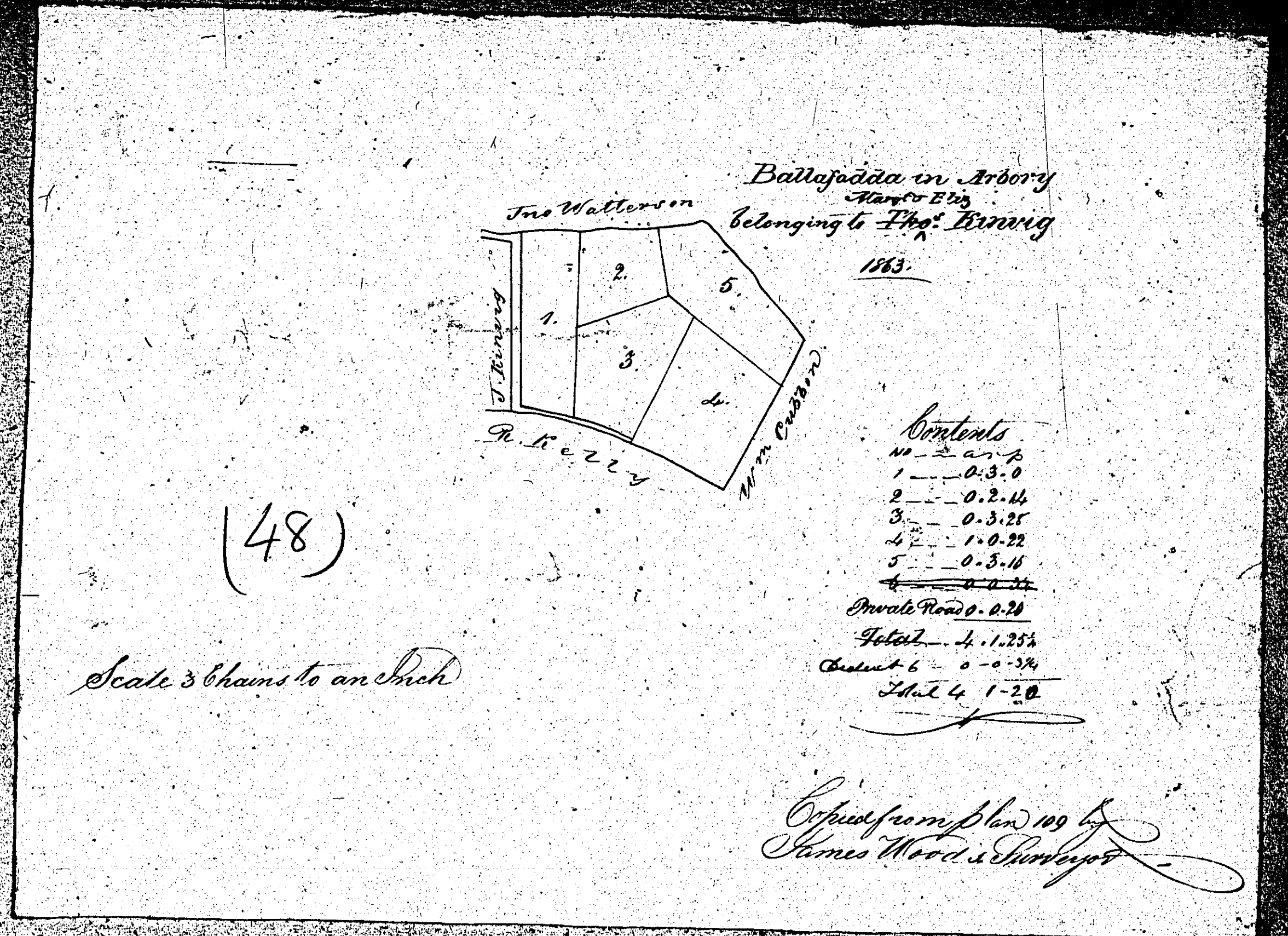

ISLE OF MAN GOVERNMENT; GENERAL REGISTRY

ASYLUM PLANS: PARISH OF ARBORY

Originals monotone

1:23

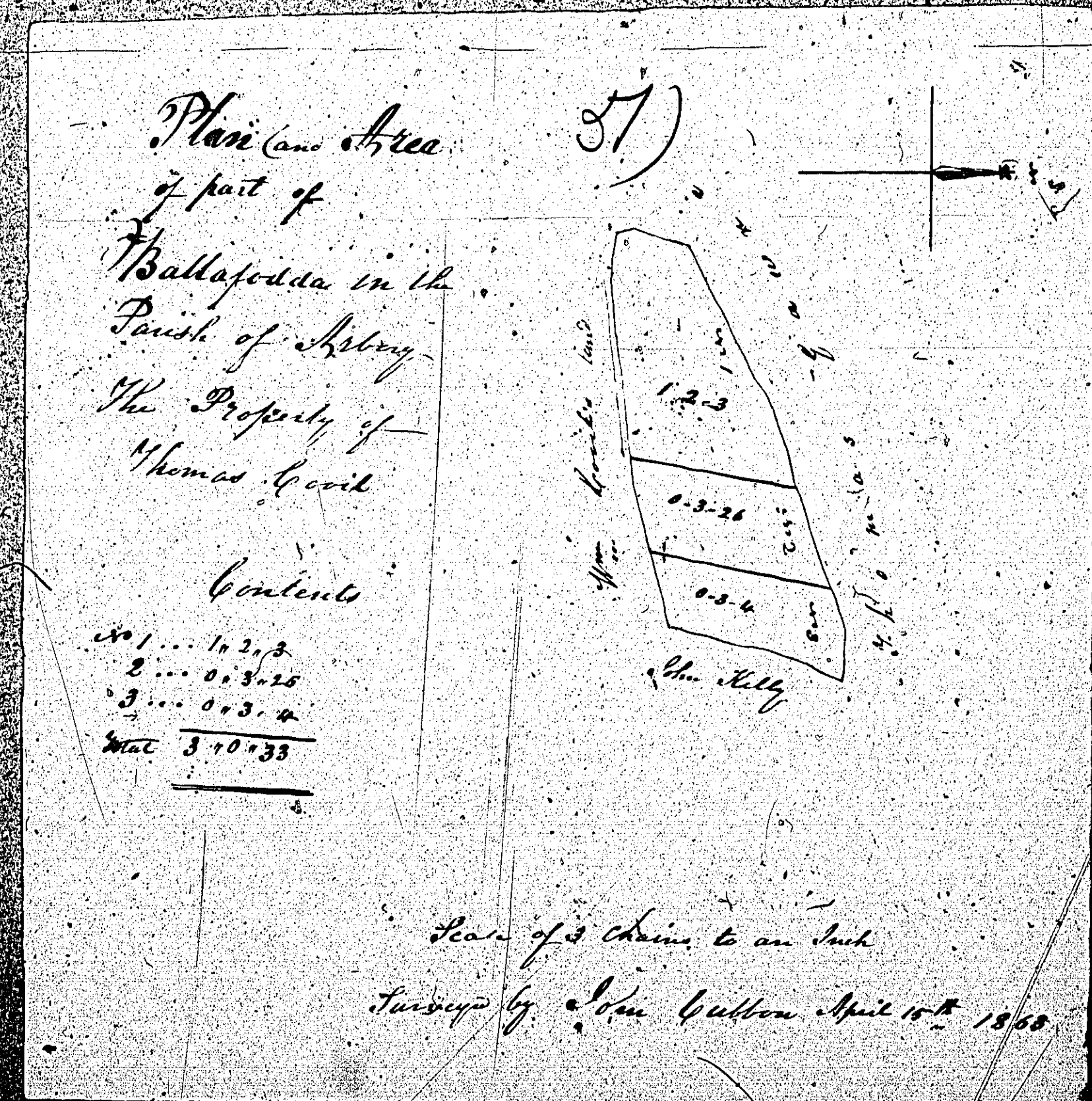
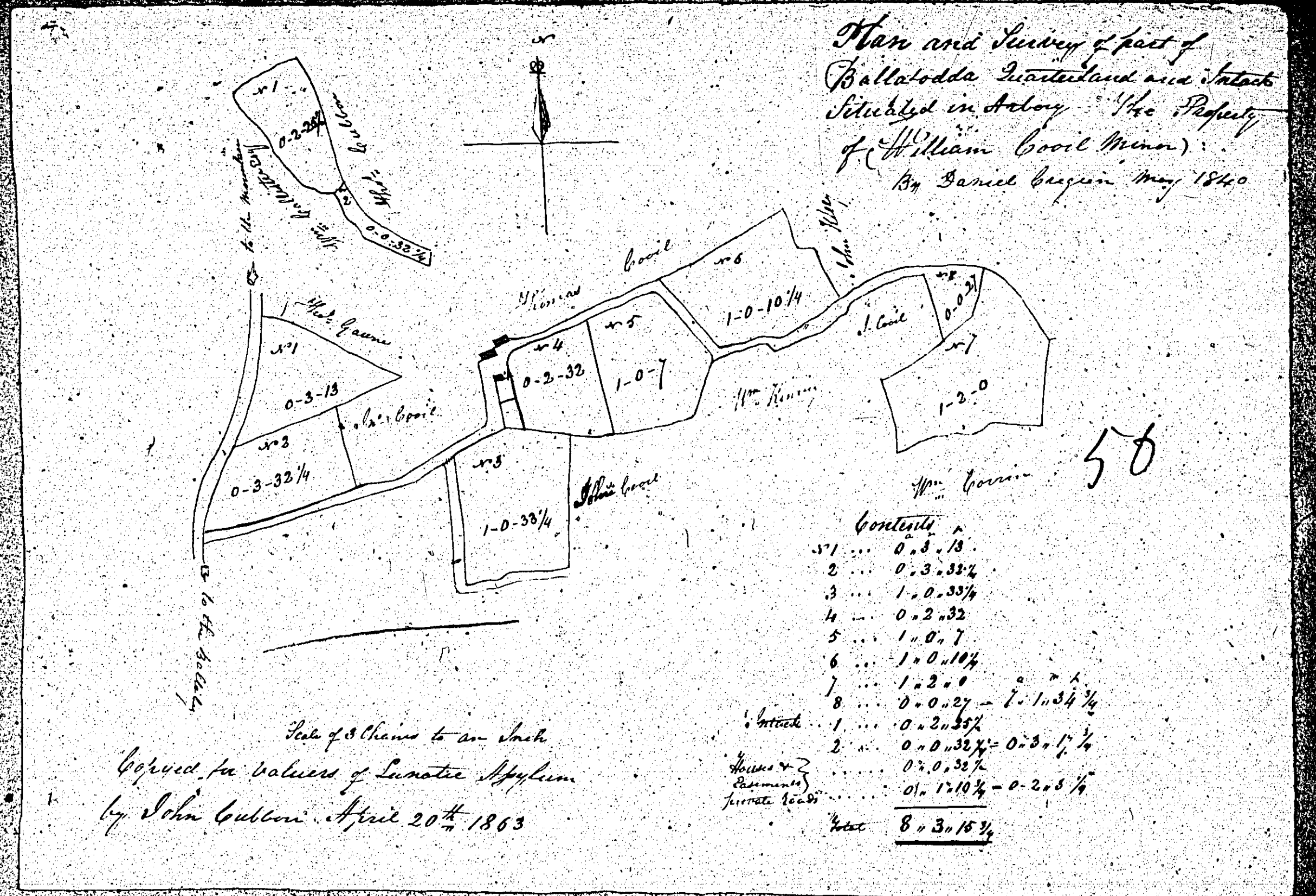

ISLE OF MAN GOVERNMENT: GENERAL REGISTRY

ASYLUM PLANS: PARISH OF ARBORY

Original monotone

1:23

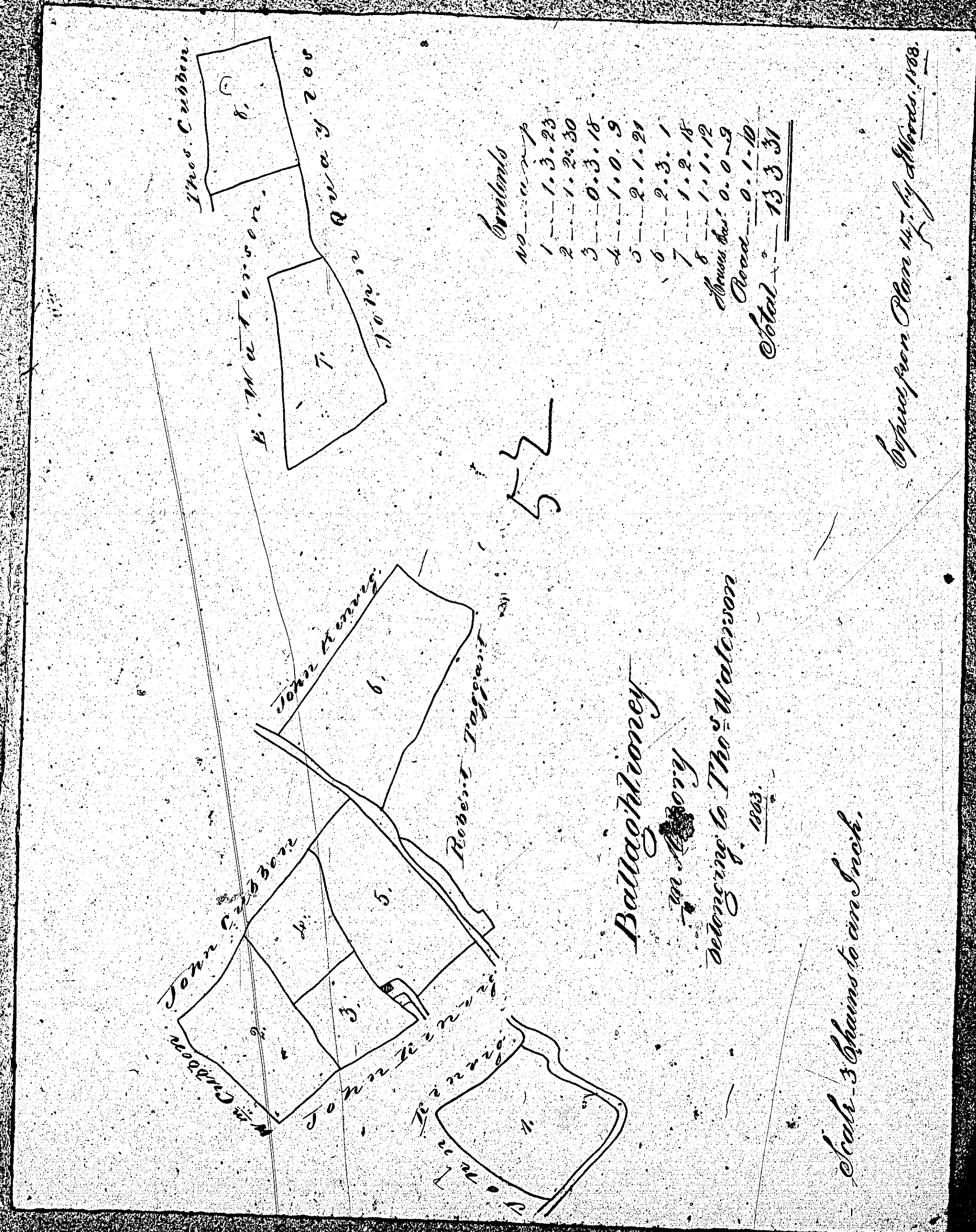

ISLE OF MAN GOVERNMENT: GENERAL REGISTRY

ASYLUM PLANS: PARISH OF ARBORY

Originals monotone

1:23

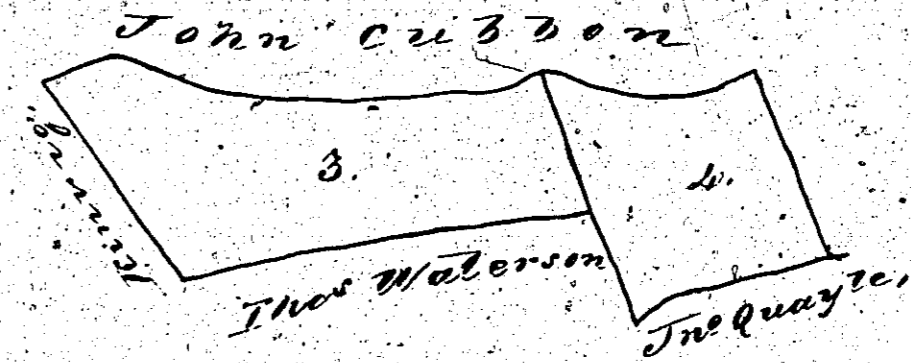
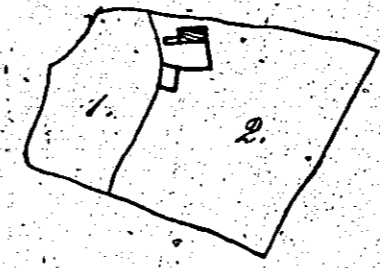

*Ballachlicney
in Arbory*

*Belonging to Elen' Waterston
1563*

Scale 3 Chams to an Inch

Contents

<i>no</i>	<i>arp</i>
1	0.1.36
2	0.3.2
3	1.3.26
4	1.0.25
<i>House</i>	<i>0.0.10</i>
<i>Total</i>	<i>4.1.22</i>

Copied from plan 47 by Woods Surveyors

54

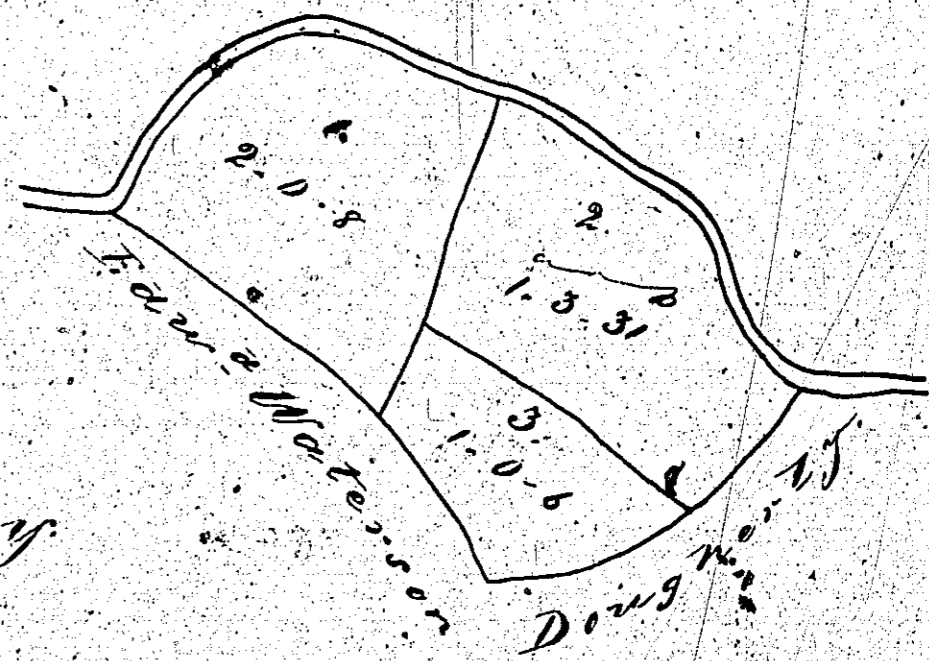

*Property in Arbory
Belonging to Rich^d Kelly
March 1863*

Scale of 3 Chams to an Inch

Contents 5.0.5

*Copied from Plans 99, 100 by
James (Hills) 1863*