

ISLE OF MAN GOVERNMENT: GENERAL REGISTRY  
ASYLUM PLANS: PARISH OF ANDREAS

Original monotone

1:23

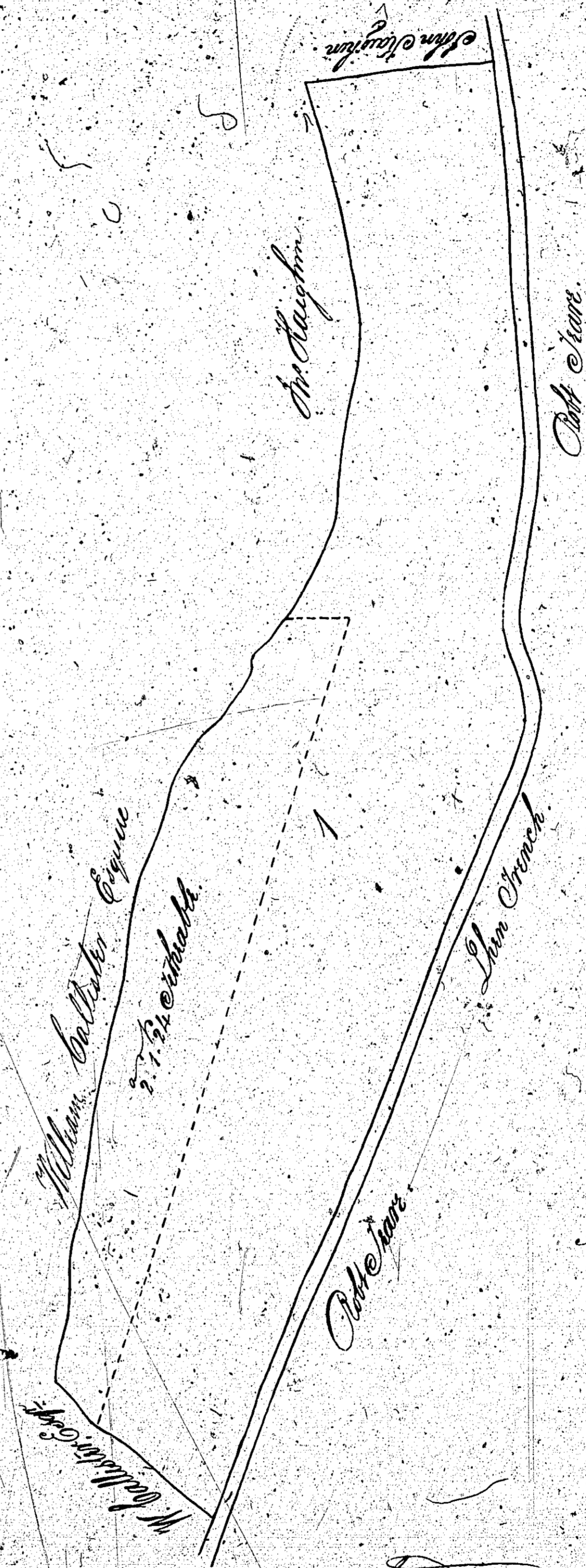

(95)  
A Parcel of Land  
in  
Andreas  
belonging to  
Robt. Seare

Tomlinson  
and  
18.1.77  
Hall of  
Asylum 1.5  
Dated 13.8.78

Scale - 2 chains to an Inch

Robt. Clouston  
Surveyor



**END OF VOLUME**

## NOTES

The plans have been filmed in their bound state

This will have caused some image distortion particularly where large plans go into the binding gutter and/or have been folded

Many of the larger plans are damaged

Where plans are coloured this has been noted; 'monochrome' indicates a single ink colour which may be black, brown or blue

**START OF VOLUME**

This is the second  
 plan numbered  
 76  
 (1<sup>st</sup> plan 76 in vol 1)

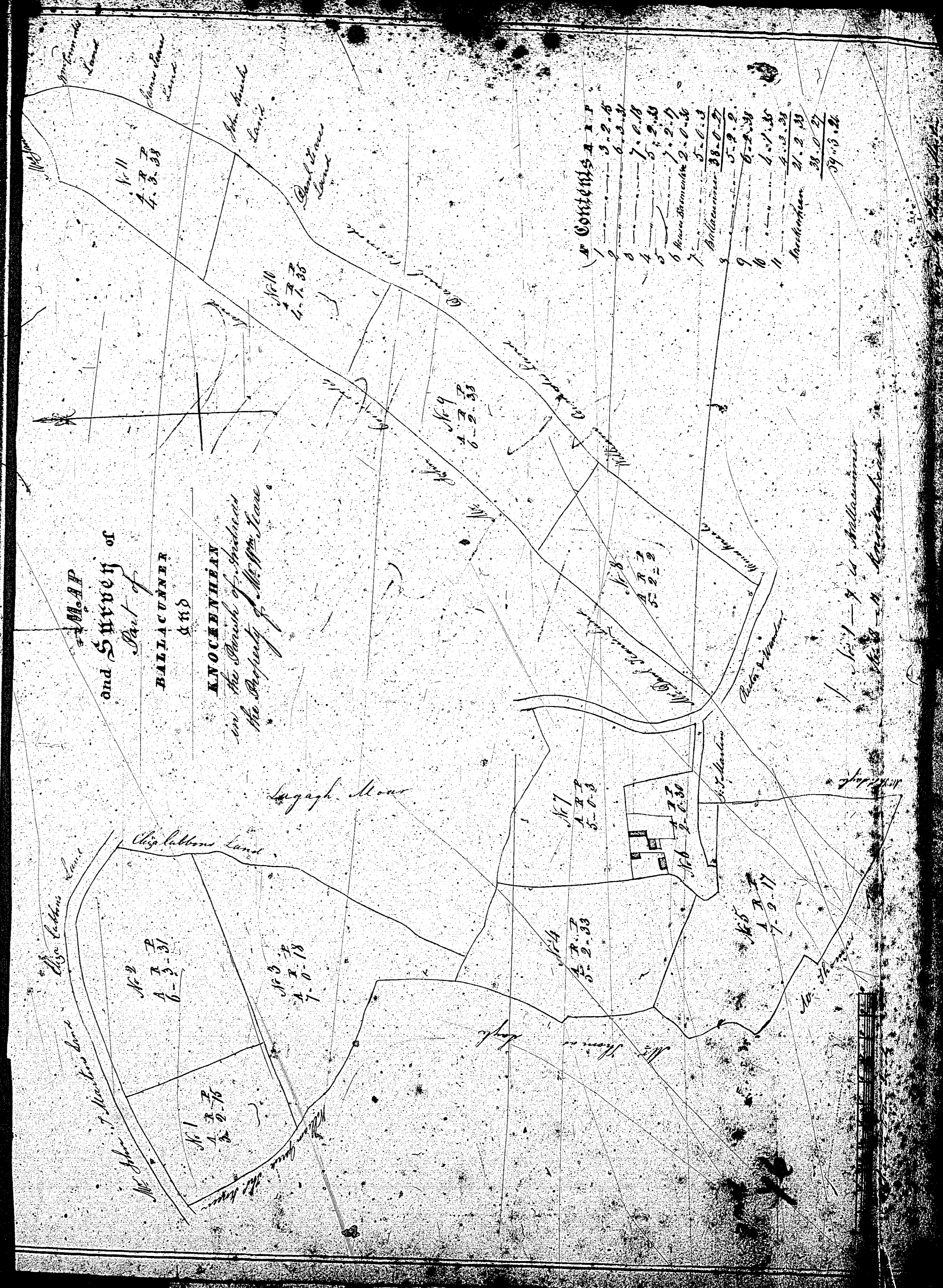

ISLE OF MAN GOVERNMENT: GENERAL REGISTRY  
 ASYLUM PLANS: PARISH OF ANDREAS

Original monotone

1:23